

WIPER PISTON EXTERNAL LIP

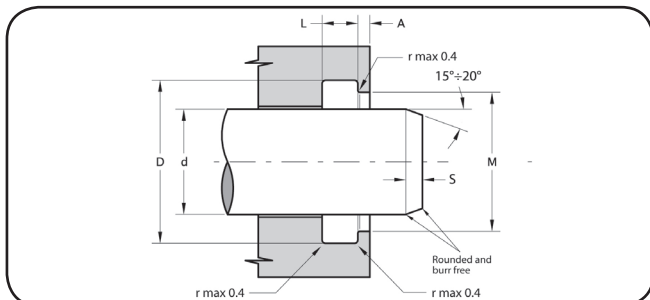

MAIN FEATURES

The SAC wiper is very useful to prevent dust, dirt and foreign matter from entering into the system, protecting the guide parts and extending the service life of the axial moving rod seals.

This is achieved by:

- A special cleaning lip that produces a very effective cleaning action and prevents the development of marks.
- An external flap that covers the gland housing, preventing the suspension from being retained and the entry of external surrounding contamination, as is the case with traditional cleaners.
- An additional outer sealing lip on the external diameter as additional protection against moisture entering the gap.

Internal ribs provide stability, prevent the cleaner from twisting and sticking in the gap, as well as relieve counterpressure between the bar seal and the cleaner.

The material used to produce this wiper is a polyurethane compound which guarantees excellent dry running properties, increased wear resistance and a long service life due to good resistance against ozone and radiation caused by weather conditions.

SAC

DESCRIPTION

Rod wiper with external sealing lip.

SEAL MATERIAL

Polyurethane. 93 °Shores

OPERATING CONDITIONS

Speed: < 0.8 m/seg.

Temperature: - 40 a + 100°C

Fluid: Hydraulic oil

(mineral based)

(For other fluids, please contact our technical department)

Surface Roughness:

Dynamic surface Ra < 0.3 µm Rt < 2.5 µm

Static surface Ra < 1.6 µm Rt < 6.3 µm

Acceptance chamfer

D	S minimum
° Less than 100 5 mm	5 mm
° From 100 to 200 7 mm	7 mm
° more than 200 10 mm	10 mm

- Outer flap for full protection against moisture penetrating into the gap.
- Suitable for harsh and heavy environments.
- Especially suitable for vertical cylinders.
- Long service life.
- Downstream pumping capacity.
- Excellent wear resistance.
- Space-saving construction.
- Easy installation without additional costs.

SAC

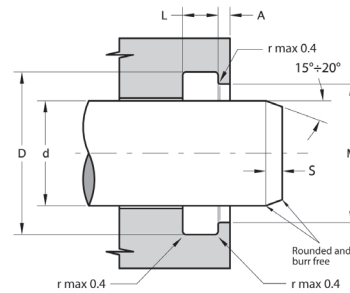

Part.	d f7	D H10	L +0.2	M H11	A +0.1
SAC 35 45 6.3	35.00	45.00	6.30	42.00	1.50
SAC 36 44 5	36.00	44.00	5.00	41.50	1.50
SAC 40 48 5	40.00	48.00	5.00	45.50	1.50
SAC 45 53 5	45.00	53.00	5.00	50.50	1.50
SAC 50 58 5	50.00	58.00	5.00	55.50	1.50
SAC 56 66 6.3	56.00	66.00	6.30	63.00	1.50
SAC 60 70 6.3	60.00	70.00	6.30	67.00	1.50
SAC 63 73 6.3	63.00	73.00	6.30	70.00	1.50
SAC 70 82.6 8	70.00	82.60	8.00	78.40	2.00
SAC 80 90 6.3	80.00	90.00	6.30	87.00	1.50
SAC 90 102.2 7.1	90.00	102.20	7.10	96.00	2.80